

INNOTEX
GRAY[™]

PARTICULATE-BLOCKING
HOODS

**SHIELD YOURSELF
FROM CONTAMINANTS**

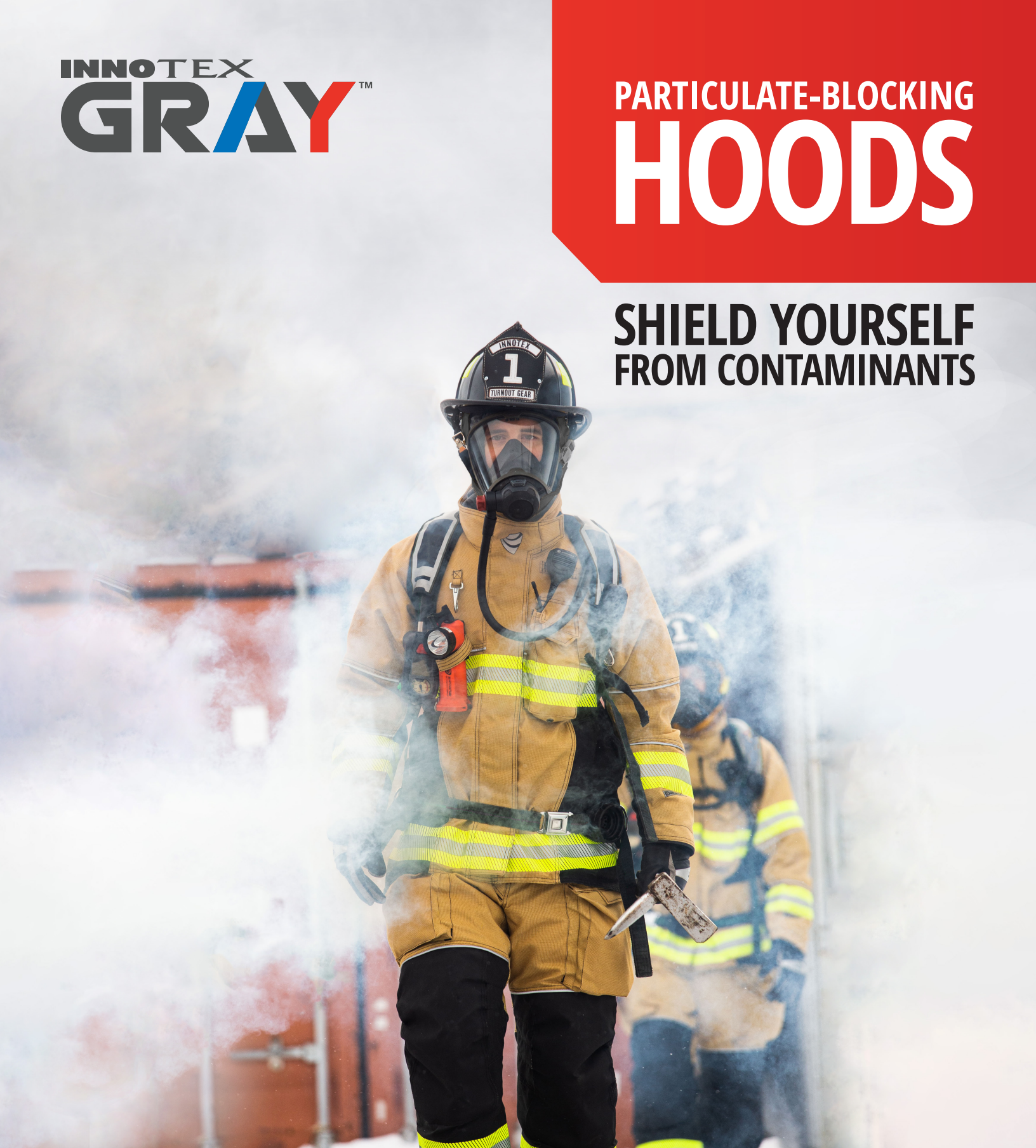

 **INNO
TEX**[®]

SOOT PARTICLES ON THE SKIN

A real risk to your health

When you set foot on the scene of a fire, you immediately come in contact with microscopic carcinogens generated by burning synthetic materials. While we know that breathing in these cancer-causing particulates is dangerous, studies show that absorption of such toxins through the skin is just as harmful.

Unseen and imperceptible, these toxic microscopic particulates can travel through traditional knitted hoods and accumulate on your skin, especially on the highly absorptive areas of the neck, jaw and throat. As a firefighter, you face intense heat and work up a sweat. All this heat opens up skin pores, increasing its ability to absorb toxins.

Traditional hoods were designed to protect against heat, not carcinogens. Today's particulate blocking hoods are of paramount importance and a vital investment in your continued health and safety.





FOR EVERY 5-DEGREE INCREASE IN SKIN TEMPERATURE, ABSORPTION INCREASES BY 400%¹

Following the lungs, the skin is the body's second largest organ in area, and it is highly absorptive. Some areas of skin are more permeable than others, specifically the face, the angle of the jaw, the neck and throat. Skin's permeability increases with temperature.

As you get hot, the pores open up, the absorption capacity of the skin increases. The higher the temperature, the more permeable your skin becomes. For every 5-degree increase in skin temperature, absorption and the risk of contamination increases by 400%¹

FIREFIGHTER CANCER QUICK FACTS

Research shows that firefighters have higher cancer risks than the general population, and their risk are significantly higher for some specific cancers.

61%² Cancer has caused 61% of career firefighter line-of-duty deaths since 2002. Heart disease caused 18% of the line-of-duty deaths.

14%¹ Firefighters have a 14% higher risk of dying from cancer than the general population.

9%¹ Firefighters have a 9% higher risk of being diagnosed with cancer than the general population.

¹Firefighter Cancer Support Network ²IAFF date 1.1.2002 to 3.31.2017

SHIELD YOURSELF FROM CONTAMINANTS

Risking your life to save others shouldn't mean you have to risk contamination from carcinogenic particles. Our INNOTEX® GRAY™ particulate blocking hoods feature an air-permeable layer of Stedair® PREVENT that acts as a filter, blocking more than 99% of all particles while allowing the unimpeded flow of clean air, thus reducing heat stress. **Fight fire with INNOTEX® GRAY™ and shield yourself from contaminants.**



BLOCKS MORE THAN 99% OF PARTICLES

STEDAIR® PREVENT particulate barrier blocks more than 99% of particles as small as 0.1 to 1.0 microns.



AIR-PERMEABLE

Allows clean air to flow through and lets moisture escape efficiently to help reduce the risk of heat stress.



DURABLE

Maintains its particulate-blocking effectiveness even after 100 washes. Face opening retains its snug fit to prevent ingress of harmful particulates.



SUPERIOR COMFORT

Lightweight and ergonomically-designed to assure a comfortable fit. Inner multi-filament FR viscose liner provides a soft, cool feeling on skin and boasts excellent moisture-wicking properties.



QUIET

Won't make crackling noises that affect your situational awareness and limit your ability to communicate.

INNOTEX
GRAY™



ULTIMATE COMFORT IN EVEN THE TOUGHEST SITUATIONS

ERGONOMIC MULTI-PANEL DESIGN

Assures a snug fit and proper seal with your SCBA, no matter the head movement, even when your head is fully leaning backward.

FULL COVERAGE

Particulate-blocking coverage throughout the entire hood.

24" EXTRA-LONG LENGTH

Provides complete chest and shoulder drape coverage. Assures your hood stays securely tucked in, preventing particulate ingress at the coat-to-neck interface.

1 HEAVY-DUTY ½" ELASTIC SEWN INTO THE FACE OPENING

Assures a snug fit and proper seal with your SCBA even when you move your head. Stretches for easy donning yet prevents the opening from stretching out of shape.

2 FLAT LOCK SEAMS

Stronger yet low-profile, ensure a more comfortable fit. All sewing done with spun Nomex thread for optimal quality.

3 FR KNIT

Form-fitting knit allows a comfortable fit that contours your head, yet does not feel constricting.

4 FR VISCOSE LINER

Provides a soft, cool feeling on skin and boasts excellent moisture-wicking properties to keep you drier and more comfortable.



PROPRIETARY PATENT PENDING TRILAMINATE

Protection against particulates is essential, and so is your comfort. Our proprietary patent pending trilaminate features industry-leading STEDAIR® PREVENT particulate-blocking barrier for optimal protection and our INNOTEX-exclusive multi-filament FR viscose inner layer for greater comfort and moisture-wicking properties. It slides like silk, always falls perfectly into place without clumping, and will not pill even after numerous washes.

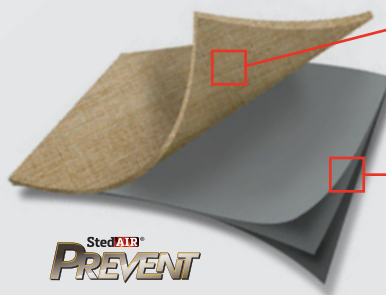

FR RIB KNIT OUTER LAYER

Choose between two knit options:

- 20% PBI – 80% Lenzing.
- 20% Nomex – 80% Lenzing.

PROPRIETARY TRILAMINATE INNER LAYER

Patent Pending

- Nomex® Lenzing.
- Particulate-blocking STEDAIR® PREVENT.
- 100% Multi-filament FR Viscose.

StedAIR®
PREVENT

4 OPTIONS TO MEET YOUR SPECIFIC TPP AND THL LEVEL REQUIREMENTS

Because you each have different needs when it comes to thermal protection and breathability, we've developed two models using our Dual Metabolic Zone design. Choose the Gray 25 hood for a better heat stress control, or opt for the Gray 35 model for optimal thermal protection on critical areas.

INNOTEX GRAY™ HOOD 25

HIGHER THL

SINGLE METABOLIC ZONE DESIGN

Effective heat stress relief, without compromising thermal protection.

TWO-LAYER HOOD

- One outer layer of FR knit.
- One inner layer of our trilaminate with Stedair® PREVENT throughout.

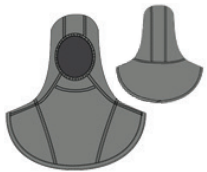

1 OUTER LAYER



TPP
AS RECEIVED
AFTER 5 WASHES
THL 427

20% NOMEX®
80% LENZING



TPP
AS RECEIVED
AFTER 5 WASHES
THL 436

* Tested at PBI® lab.
** Nominal values.

20% PBI®
80% LENZING

INNOTEX GRAY™ HOOD 35

HIGHER TPP

DUAL METABOLIC ZONE DESIGN

Provides higher thermal and flashover protection only where you need it most.

THREE-LAYER HOOD

- Two outer layers of FR knit on critical areas.
- One inner layer of our unique trilaminate with Stedair® PREVENT throughout.

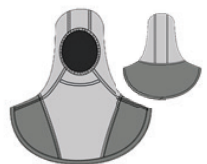

2 OUTER LAYERS

1 OUTER LAYER



TPP
AS RECEIVED
AFTER 5 WASHES
THL 329

20% NOMEX®
80% LENZING



TPP
AS RECEIVED
AFTER 5 WASHES
THL 350

20% PBI®
80% LENZING

INNOTEX
GRAY™

TECHNICAL INFORMATION

FABRIC PERFORMANCE VALUES

Requirements
NFPA 1971,
2018 EDITION

INNOTEX GRAY™ HOOD 25

INNOTEX GRAY™ HOOD 35

MATERIAL			20% Nomex 80% Lenzing	20% PBI 80% Lenzing	20% Nomex 80% Lenzing	20% PBI 80% Lenzing
COLOR			Gray	Tan	Gray	Tan
OVERALL LENGTH			24"	24"	24"	24"
PARTICULATE-BLOCKING EFFICIENCY	As received	0.10mm particle size ≥ 90%	99.9%	99.6%	99.9%	99.6%
	After 10 launderings		99.8%	99.3%	99.8%	99.3%
THERMAL PROTECTIVE PERFORMANCE (TPP)	As received	≥20	22.6	22.37*	36.7	38.6
	After 5 launderings	≥20	34.1	25**	47.2	34.8
TOTAL HEAT LOSS (THL)	As received	≥325 W/m2	427	437	329	350
AFTER FLAME (Wales X Courses) (sec)	As received	≤ 2.0	0	0	0	0
	After 5 launderings		0	0	0	0
CHAR LENGTH (Wales X Courses) (mm)	As received	≤ 2.0	23 x 18	20 x 28	23 x 18	20 x 28
	After 5 launderings		18 x 16	30 x 28	18 x 16	30 x 28
HEAT AND THERMAL SHRINKAGE RESISTANCE (%)	As received	≤ 10%	M/L: -0,5% XL: -0,3%	M/L: -0,8% XL: -1,5%	M/L: -0,2% XL: 0%	M/L: 0% XL: 0%
	After 5 launderings		M/L: -0,5% XL: -0,5%	M/L: -1,4% XL: -1,6%	M/L: -0,2% XL: 0,3%	M/L: 0% XL: 0,2%
CLEANING SHRINKAGE RESISTANCE (%)	Finished hood	≥5%	M/L: -1% XL: -1,6%	M/L: -1% XL: -1,6%	M/L: -1,0% XL: -1,0%	M/L: 0% XL: -2,0%
FABRIC BURST STRENGTH	Knit	≥225 N	480	345	480	345
	Stedair Prevent		546	546	546	546

FABRIC PERFORMANCE VALUES IN ACCORDANCE WITH NFPA 1971-2018. PERFORMED BY UNDERWRITERS LABORATORIES.

* TESTED AT PBI® LAB. ** NOMINAL VALUES.

SIZING

Measure your head circumference and refer to the chart to select your size.

SIZES	HEAD CIRCUMFERENCE (INCHES)
M/L	< 23.5"
XL	23.5" to 25"



**INNOTEX® USA**

2397 Harts Ferry Road
Ohatchee, AL 36271
USA

**INNOTEX® CANADA**

275 Gouin Street
Richmond (Quebec)
Canada, J0B 2H0

CUSTOMER SERVICE

1-888-821-3121 (U.S. & Canada)
Tel: 819-826-5971
Fax: 819-826-5195

• DUPONT •

Kevlar® | **Nomex®**



PERFORMANCE
PRODUCTS, INC.



® Registered Trademark of INNOTEX INC. or their respective holders. Copyright 2019 INNOTEX INC.
All rights reserved. Because of our ongoing commitment to product quality and development we reserve the right to change,
cancel, discontinue or alter any specification, design or feature without prior notice and without incurring obligation.